

ROBERTS' ADJUTANT

CORNER VISITATION:

The monuments shown as found and tied hereon were visited in November of 2018.

SURVEYOR'S CERTIFICATE:

This map correctly represents a survey made under my direction in conformance with the of the Survey Recording Act at the request Harper in November of 2018.

Jason Michael VonLindern

Jason Michael VonLindern, PLS 54528



DEED OF SURVEY

ROBERT'S ADDITION LOCATED IN THE
 QUARTER OF SECTION 23, TOWNSHIP 19
 MERIDIAN, CITY OF OAKESDALE, WHITMAN
 COUNTY, WASHINGTON

CALCULATED
 POSITION, NOT
 SEARCHED FOR

23

PROPERTY LINE

SECTION LINE

1/4 SECTION LINE

EXISTING CENTERLINE

EXISTING RIGHT OF WAY LINE

EXISTING LOT LINE

EXISTING FENCE

SECTION CORNER
 AS NOTED

1/4 SECTION CORNER
 AS NOTED

FOUND MONUMENT
 SEE CORNER NOTES

SET 5/8" REBAR
 WITH YPC MARKED
 "VONI INDFRN PLS 54528"



F1

SOUTH

AUDITOR'S CERTIFICATE:

Filed for record this 20th Day of Dec. 2018, at
10:35 A.M. in Book 10 of Survey
 Page 122, Auditor's File Number # 150651 at the
 request of Parametrix Rebar Pals
 Whitman County Auditor

OFFICIAL DOCUMENTS:

- R1 Statutory Warranty Deed, AFN 749957, 10/31/18, Whitman & Rickett to Harper.
- R2 United States Government Land Office (GLO) Plat of Township 19 North, Range 44 East, Willamette Meridian, compiled January 1, 1874, Surveyor: Briggs.
- R3 Whitman County Engineer's Corner Record P-17, Book 2, Page 46, 1/4 corner common to Sections 22 & 23 Township 19 North, Range 44 East, Willamette Meridian, by Melvin Taggart, July 3, 1996.
- R4 Roberts' Addition to Oakesdale, Surveyor: Unknown.
- R5 Survey for McGregor & Co-Ag, AFN 745713, 2018, Surveyor: Murtha.
- R6 Survey for Mr. Allan and Mrs. Pat Barth, AFN 657303, 2004, Surveyor: Taggart.
- R7 Survey for Mr. and Mrs. Allan Barth, AFN 71760, 1993, Surveyor: Taggart.
- R8 Survey for Oakesdale Cemetery, AFN 71661, 1990, Surveyor: Benethin.

CORNER NOTES:

- F1 Found 5/8" Rebar with YPC marked "Taggart 8446", 0.8' below asphalt surface in road.
- F2 Found 2" aluminum cap, no markings, 1.5'± below surface.
- F3 Found 3" brass cap marked "WHITMAN COUNTY MONUMENT, T16 R44, 22 23 27 26, WASHINGTON LS REG NO _____", 1' below surface.
- F4 Found 1" square head bolt, 0.3' below surface, 6.18' south of E-W fence line.
- F5-F10 Found 5/8" Rebar with YPC marked "Taggart 8446", 0.5' below surface.
- F11 Found 3/4" Rebar, no cap, 0.6' below surface, 1.56' east and 0.67' south of the calculated southwest corner of Block 8 J.H. McCoys

UNPLATTED

+ CALCULATED ANGLE
POINT, NOTHING SET

(R1) RECORD INFORMATION
SEE OFFICIAL DOCUMENTS

YPC YELLOW PLASTIC CAP

AFN AUDITOR'S FILE NUMBER

Northwest corner of Block 2, Roberts' Addition, accepted for East-West line, did not accept North-South location.

SURVEYORS NOTES:

1. We accepted the monuments F1, F2 and F3 as the Westerly line of Section 23.
2. We determined the north line of Roberts' Addition to Oakesdale by running the line between monuments F1 and F4.
3. The monuments F5-F10 were used to best fit the Right of Way lines for Roberts, Bartlett, and Gay streets as per record drawings (R4)(R6)(R7)
4. Record R7 shows monuments being set on the North line of Lot 3. We found said monuments on the South line of Lot 2 and the Northwest corner of Lot 2.
5. No Title search was conducted. There may be easements, covenants, restrictions or other matters affecting the subject property, but not shown, that would be disclosed by a current Title Report.

BASIS OF BEARINGS:

The Bearing of North 00°00'51" East 2691.75 feet was assumed along the Westerly line of the Southwest Quarter of Section 23, Township 19 North, Range 44 East, Willamette Meridian, between monuments F3 and F1.

PURPOSE OF THE SURVEY:

This Record of Survey was requested by Roberta Ann Harper to locate the property lines of Lot 2 and a portion of Lot 1 Block 1 per her deed (R1) and to monument any missing property corners.

LAND DESCRIPTION PER (R1)

Lots 1 and 2, Block 1 Roberts' Addition to Oakesdale according to the plat thereof, recorded in Volume C of Plats, page 13, records of Whitman County, Washington.

ACCURACY STATEMENT (WAC 332-130-100)

This survey was performed using a Leica TS15P, 3-Second Total Station and a Leica GS14 Performance Smart Antenna for a combination of field traverse and GPS survey methods to meet or exceed the required standards for land boundary surveys per WAC 332-130-090.

EXCEPT the west 150 feet of said Lot 1.

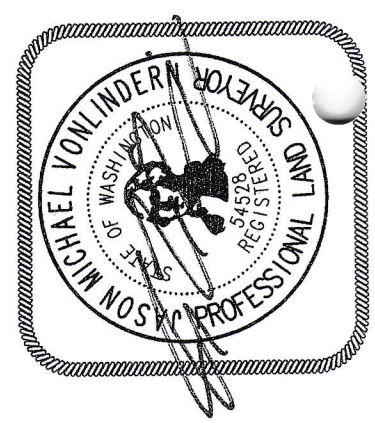

me or
uirements
Roberta Ann

-15-18
DATE

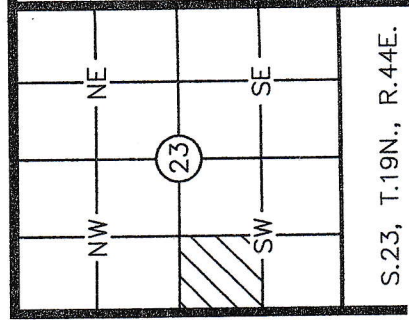

Parametrix
ENGINEERING · PLANNING · ENVIRONMENTAL SCIENCES

245 E MAIN STREET | PULLMAN, WA 99163
P 509.334.5115 WWW.PARAMETRIX.COM

DATE: 12-12-18
FIELD CREW: JMV
DWN: DJR CK'D: JMV
PROJ.#: 387-8251-001
DWG: PL8251001V-R0S.dwg

SURVEY FOR
ROBERTA ANN HARPER

SHEET
1 OF 1