

ORDINANCE NO. 2965

AN ORDINANCE ANNEXING PROPERTY COMMONLY KNOWN AS GOOD FAITH 4 ALL ANNEXATION TO THE CITY OF MOSES LAKE, WASHINGTON, AND INCORPORATING THE SAME WITHIN THE CORPORATE LIMITS OF THE CITY OF MOSES LAKE

THE CITY COUNCIL OF THE CITY OF MOSES LAKE, WASHINGTON DO ORDAIN AS FOLLOWS:

Section 1. The following described real estate, as shown on the attached map marked Exhibit A which by this reference is incorporated within this ordinance, situated in Grant County is hereby annexed to the City of Moses Lake.

POR LOT 4 THIEME SP 21-90 & POR N1/2NW 19 19 29 (TGW PER BLA) LOT 4 THIEME SP 21-90 ALL OF PARCEL 4 OF THE THIEME SHORT PLAT, AS RECORDED IN BOOK 21 OF SHORT PLATS, AT PAGES 90 THROUGH 93, RECORDS OF GRANT COUNTY, WASHINGTON & POR N/12 NW 19 19 29 EXCEPT THAT PORTION OF PARCEL 4 OF THE THIEME SHORT PLAT, AS RECORDED IN BOOK 21 OF SHORT PLATS, AT PAGES 90 THROUGH 93, RECORDS OF GRANT COUNTY, WASHINGTON, LYING WITHIN THE FOLLOWING DESCRIBED AREA: THAT PORTION OF PARCEL 4 OF THIEME SHORT PLAT, AS RECORDED IN BOOK 21 OF SHORT PLATS, AT PAGES 90 THROUGH 93, RECORDS OF GRANT COUNTY, WASHINGTON, BEING A PORTION OF FARM UNIT 89, IRRIGATION BLOCK 41, COLUMBIA BASIN PROJECT, AND THAT PORTION OF THE NORTH HALF OF THE NORTHWEST QUARTER OF SECTION 19, TOWNSHIP 19 NORTH, RANGE 29 E.W.M., GRANT COUNTY, WASHINGTON, DESCRIBED AS FOLLOWS: BEGINNING AT A BRASS CAP MONUMENT MARKING THE NORTHWEST CORNER OF SAID SECTION, SAID POINT BEARS NORTH 00°24'04" EAST, 2680.04 FEET, FROM A BRASS CAP MONUMENT MARKING THE WEST QUARTER CORNER OF SAID SECTION; THENCE SOUTH 89°32'57" EAST, FOLLOWING THE NORTH BOUNDARY OF SAID FARM UNIT AND SAID SECTION, 650.80 FEET TO A NORTHERLY CORNER OF SAID FARM UNIT AND THE TRUE POINT OF BEGINNING; THENCE CONTINUING SOUTH 89°32'57" EAST, 650.79 FEET TO A NORTHERLY CORNER OF SAID FARM UNIT AND AN INTERSECTION WITH THE CENTERLINE OF THE U.S.B.R. EL2OUI RIGHT-OF-WAY; THENCE SOUTH 00°29'08" WEST, FOLLOWING SAID CENTERLINE 40.00 FEET TO AN INTERSECTION OF THE SOUTHERLY RIGHT-OF-WAY BOUNDARY OF WHEELER RD AND A NORTHERLY CORNER OF SAID PARCEL 4; THENCE NORTH 89°32'57" WEST, FOLLOWING SAID SOUTHERLY RIGHT-OF-WAY BOUNDARY AND PARALLEL WITH THE NORTH BOUNDARY OF SAID SECTION, 55.68 FEET, TO A HALF INCH REBAR WITH SURVEYOR'S CAP STAMPED "LOLKUS LS 41292"; THENCE SOUTH 19°42'02" EAST, 264.96 FEET TO A HALF INCH REBAR WITH SURVEYOR'S CAP STAMPED "LOLKUS LS 41292" THENCE SOUTH 00°29'08" WEST, 147.76 FEET TO A HALF INCH REBAR WITH SURVEYOR'S CAP STAMPED "LOLKUS LS 41292"; THENCE SOUTH 09°24'34" WEST, 230.46 FEET TO A HALF INCH REBAR WITH SURVEYOR'S CAP

STAMPED "LOLKUS LS 41292"; THENCE SOUTH 89°56'49" WEST, 650.33 FEET TO A CORNER OF SAID PARCEL 4, SAID POINT BEING MARKED BY A FOUND 5/8 INCH REBAR WITH SURVEYOR'S CAP STAMPED "LS 41292"; THENCE NORTH 00°26'36" EAST, FOLLOWING THE BOUNDARY OF SAID PARCEL 4, 669.87 FEET TO THE TRUE POINT OF BEGINNING. TOGETHER WITH AND SUBJECT TO EASEMENTS, RESERVATIONS AND RESTRICTIONS OF RECORD.

Section 2. All property within the territory annexed shall hereinafter be assessed and taxed at the same rate and on the same basis as other property within the City.

Section 3. The area annexed will be zoned LI-Light Industrial.

Section 4. That a copy of this ordinance shall be filed with the Board of County Commissioners of Grant County, Washington, as well as the Grant County Treasurer, Grant County Assessor, and State Office of Financial Management.

Section 5. This Ordinance shall take effect from and after its passage on the later of sixty (60) days after publication of such Ordinance once in The Columbia Basin Herald, the same being the official newspaper of the City of Moses Lake, and in accordance to notifications required by state statute.

Adopted by the Moses Lake City Council and signed by its Mayor on February 9, 2021.



David Curnel, Mayor

ATTEST:



Debbie Burke, City Clerk

APPROVED AS TO FORM

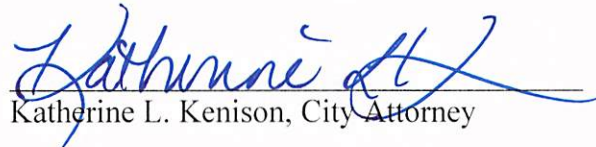

Katherine L. Kenison, City Attorney



Vote:	Riggs	Liebrecht	Myers	Jackson	Curnel	Eck	Hankins
Aye	✓	✓	✓	✓	✓	✓	✓
Nay							
Abstain							
Absent							

Date Published: February 15, 2021

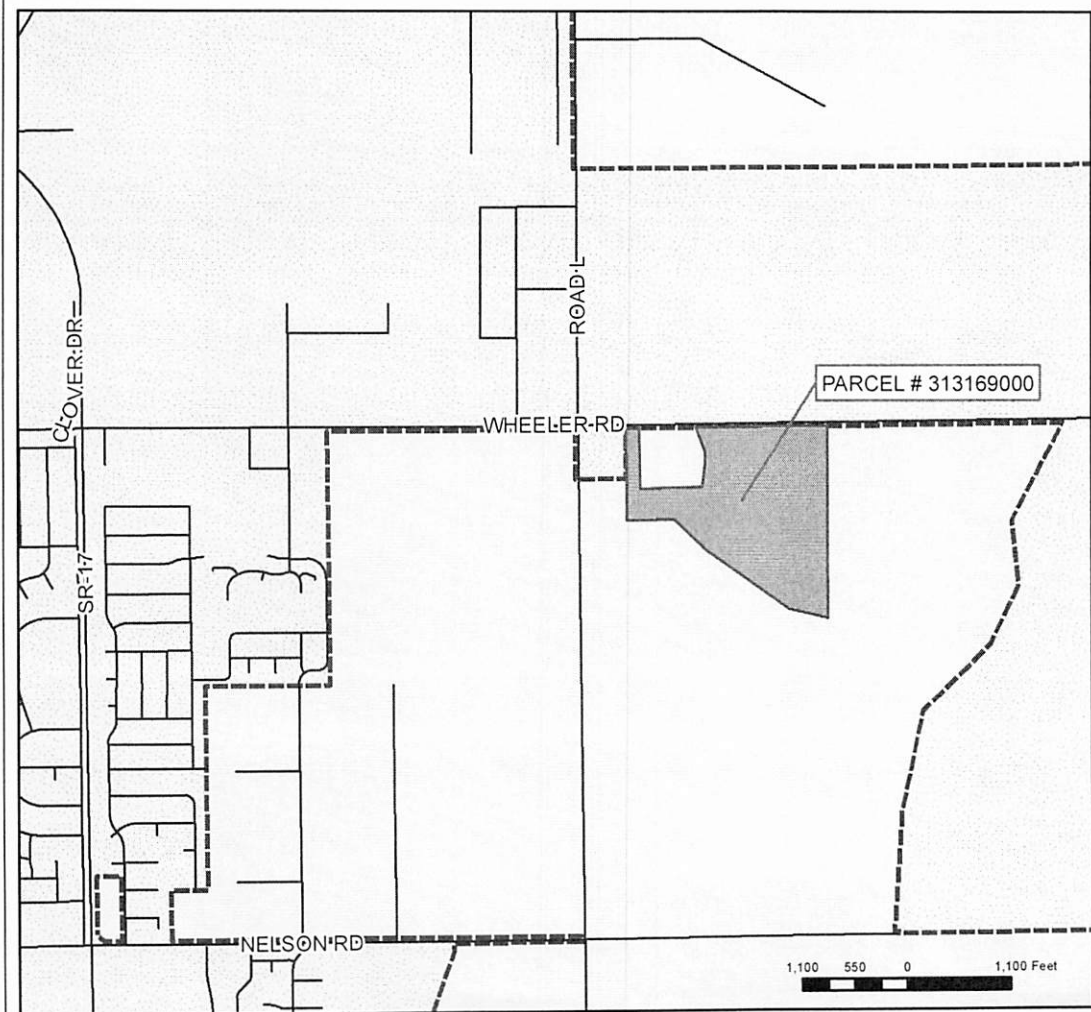
Date Effective: April 16, 2021



LEGEND

-  Council Agenda Site
-  City Limits



Good Faith 4 All
Annexation



COMMUNITY DEVELOPMENT
PLANNING DIVISION
CITY OF MOSES LAKE

Date: 1/21/2021