

PROPOSED ANNEXATION TO THE CITY OF SUMNER

SE 1/4 OF THE SE 1/4 OF SECTION 23, T.20 N., R. 4 E., W.M.
PIERCE COUNTY, WASHINGTON

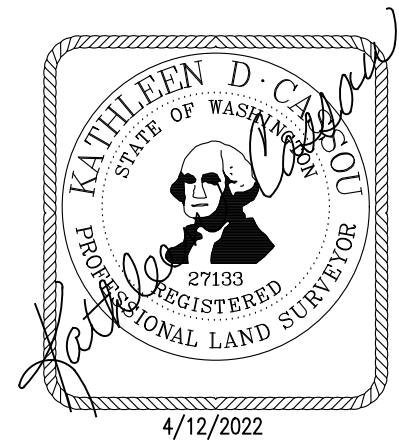
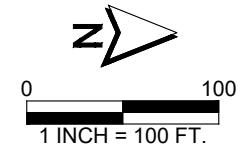

**TOTAL AREA = 551,693
SQ. FT. (12.67 ACRES)**

P.O.B.
NE COR, SE 1/4, SE 1/4,
SEC 23 STONE MONUMENT OF
RECORD SEARCHED FOR, NOT
FOUND CALCULATED PER
PUBLISHED RECORDS

NOTE: THE BASIS OF BEARINGS IS THE NORTH AMERICAN DATUM OF 1983 (NAD83), ADJUSTMENT 2011, WASHINGTON STATE PLANE, SOUTH ZONE, BASED ON VERIFICATION TIES TO WSDOT MONUMENT DESIGNATIONS "HL-004" AND BM27 167-18".

Parametrix
ENGINEERING . PLANNING . ENVIRONMENTAL SCIENCES

SURVEYED MK		SHEET NO. 1 OF 1
DRAWN SNS		
CHECKED KC	SCALE 1"=100'	
APPROVED KC	DATE 04/12/2022	

