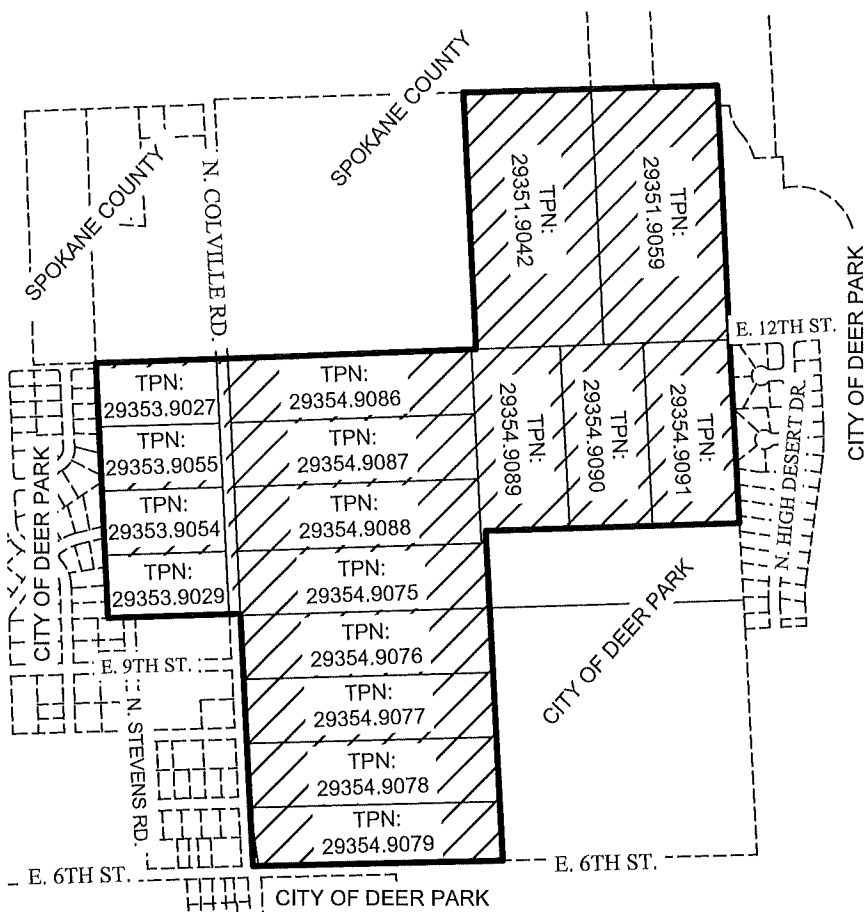

EXHIBIT 'B'



TPN = TAX PARCEL NUMBER

CURRENT ZONING DESIGNATION
RURAL TRANSITIONAL

PROPOSED CITY ZONING DESIGNATION
SINGLE FAMILY RESIDENTIAL - 2B

COMPREHENSIVE PLAN
SINGLE FAMILY RESIDENTIAL

ANNEXED AREA SIZE (GROSS)
169.61 ACRES



ANNEXATION EXHIBIT

SECTION 35, TOWNSHIP 29 NORTH, RANGE 42 EAST,
WILLAMETTE MERIDIAN, CITY OF DEER PARK
SPOKANE COUNTY, WASHINGTON

Johnson
Surveying

DATE SURVEYED: JAN. 2022

DRAFTED BY: DTL

PROJECT No.: 22-013

P.O. Box 2544 Post Falls, ID 83877
208-660-2351

PLOT DATE: 10/12/2023

CHECKED BY: DTL

PAGE: 1 OF 1

johnsonsurveyingnw.com