

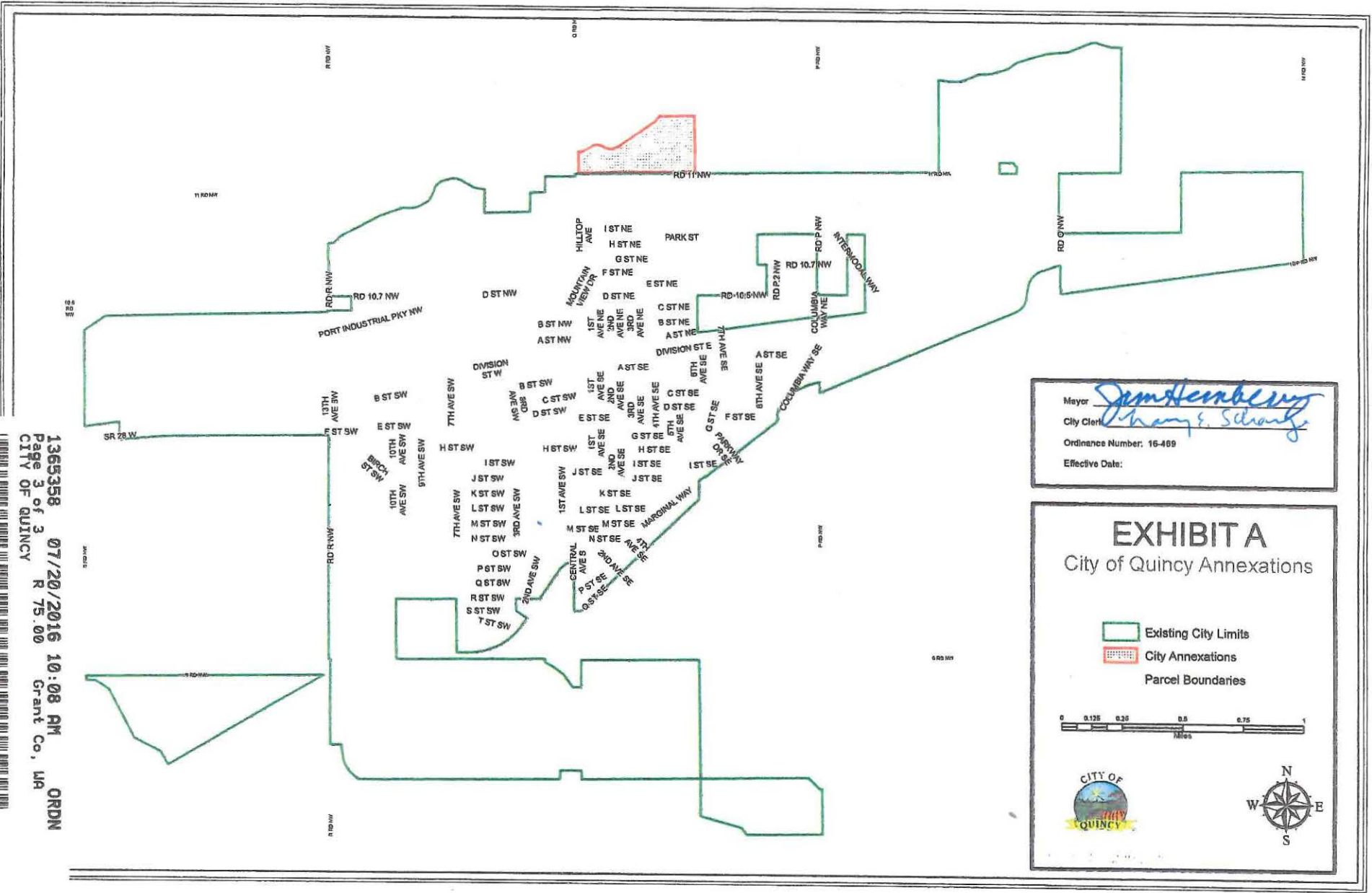

1365358 07/20/2016 10:08 AM ORDN
 Page 3 of 3 R 75.00 Grant Co., IA
 CITY OF QUINCY



Mayor *Jim Hensberry*
 City Clerk *Cheryl Schantz*
 Ordinance Number: 16-489
 Effective Date:

EXHIBIT A

City of Quincy Annexations

- Existing City Limits
- City Annexations
- Parcel Boundaries

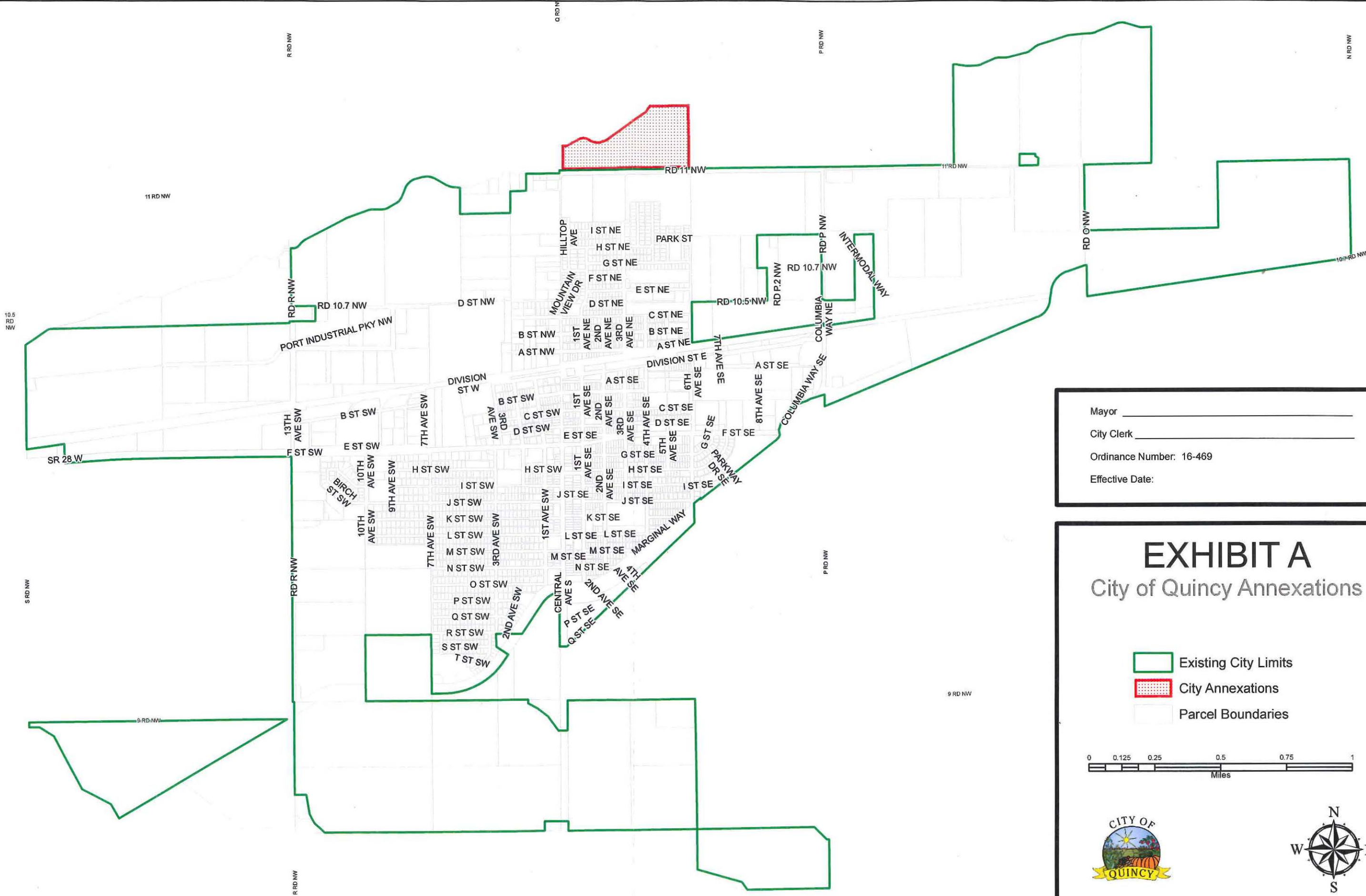



Mayor _____
 City Clerk _____
 Ordinance Number: 16-469
 Effective Date: _____

EXHIBIT A

City of Quincy Annexations

- Existing City Limits
- City Annexations
- Parcel Boundaries

0 0.125 0.25 0.5 0.75 1
Miles

Map produced by JLB, Erlandsen, Inc. 4/30/2015
 File: M:\11 Jobs\2013\20130083_0000\GIS\Maps\Annex2015.mxd